

PRODUCT CATALOGUE

LOCAL



member of the LEMKEN group



THE COMPANY

EQUALIZER is a South African-based company established in the year 2000 by Gideon Schreuder, qualified mechanical engineer and farmer at the time.

Innovative design, quality product, on-time delivery and sustainable after-sale service were the building blocks of what is today the market leader, by a country mile, in the fields of grain seeding and planting in South Africa.

The astounding success of EQUALIZER in South Africa set the scene for big things to come.

In 2013 EQUALIZER dipped it's toes in the Australian seeder market.

Today EQUALIZER is taking the lead in seeder sales in Western Australia and is looking forward to equally successful growth opportunities in the Eastern states.

This was not the only export market tackled by this young and dynamic company.

In 2017 the sights were turned towards Eastern Europe. The brand is now exposed to a number of countries in Eastern Europe and with positive and exiting results the future looks bright!



With a young and energetic product development team, world-class manufacturing facility and dedicated people, EQUALIZER is destined to become one of the leading brands in the fields of grain seeding and planting. This position is now further strengthened by the acquisition of EQUALIZER by the most trusted name in soil cultivation, LEMKEN.

LEMKEN with its worldwide network of dealers will simply fast track the process of bringing this new and existing brand to grain growers all over the world.

WORLD-CLASS PRODUCT AND PRODUCTION



The EQUALIZER factory is located in Brackenfell, a suburb of the most beautiful city in the world, Cape Town, South Africa. Expansion of the facilities is high on the priority list to meet the ever-growing demand for the product.



Over the past 24 years, EQUALIZER has established a world-class production facility with state-of-the-art ERP(Enterprise Resource Planning) systems forming the heart of the operation. Quality assurance processes are integrated throughout the facility, assuring quality of the highest standards.

Product development

Innovative ideas get transformed into workable solutions through state-of-the-art CAD modelling software.

This team of engineers is taking EQUALIZER products to new heights.

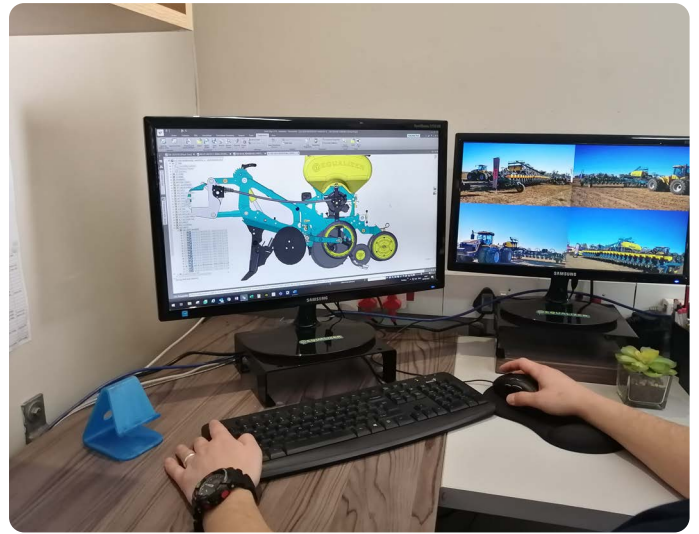
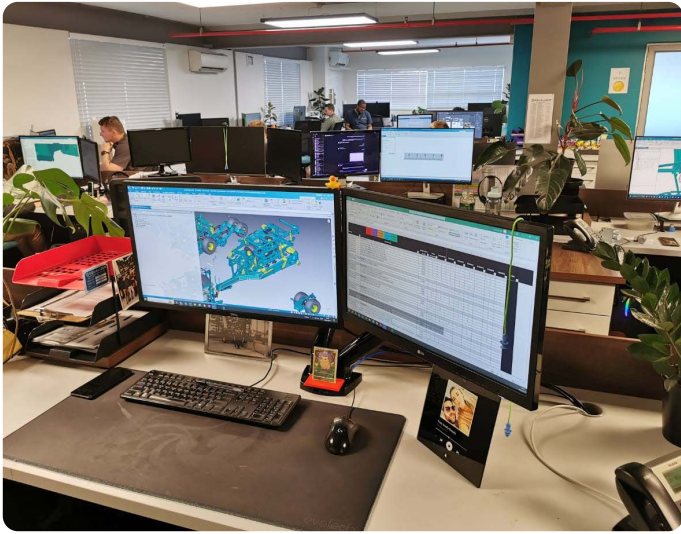

Fabrication and painting

One of the cornerstones of good product stems from a well-organized environment and highly skilled labor force, combined with a good dose of mechanization. Nowhere is this more prevalent than in these two departments.

The recipe is simple. Skilled artisans, robot welders, automated chemical treatment and coating plant plus top-end materials.

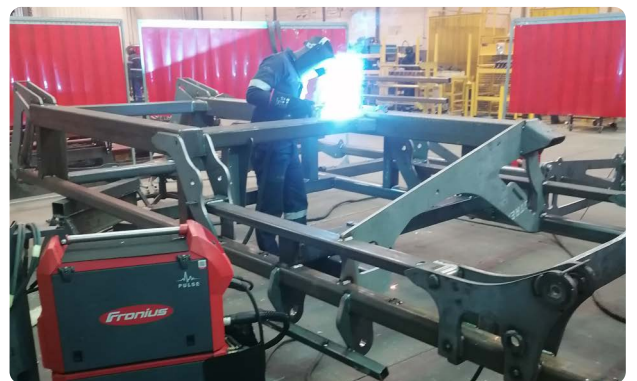
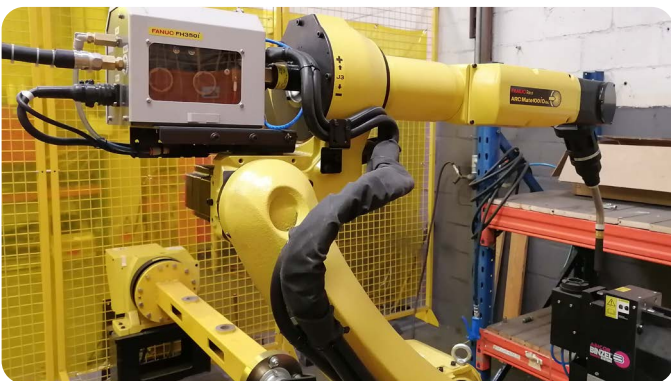

Final assembly

The meticulous attention to detail in getting all the components together is what's called for to make every Equalizer work like a Swiss clock.



Spare parts

On-time spare parts delivery rely on the very user-friendly 3D spare parts catalog available online to all dealers and clients. The spare parts team has also a pivotal role to play in assuring fast and efficient service.

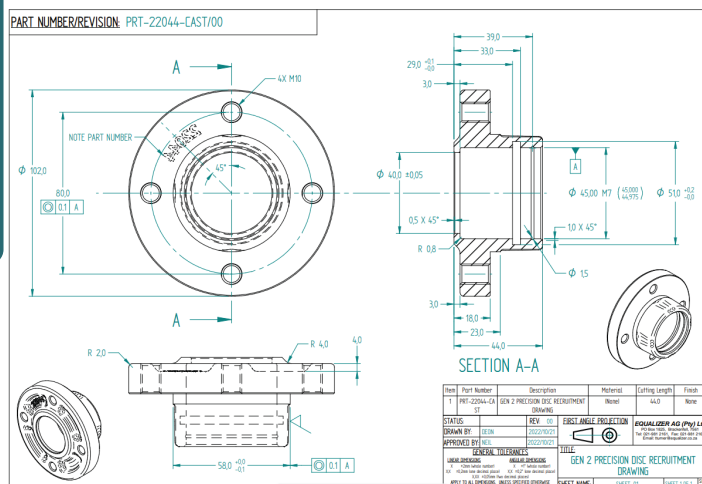

EQUALIZER
PLANTING YOUR FUTURE

Spare Parts catalogue Search products

Code

Spare Parts Catalogue / PLANTERS / PRE-TILL PRECISION C / 2022 / C2022004

3D model structure

- 1 C2022004-FRAME AND WHEELS - FRAME AND WHEELS
- 1 C2022004-MISCELLANEOUS - MISCELLANEOUS
- 1 C2022004-ROW UNITS - ROW UNITS
- 1 C2022004-HYDRAULICS - HYDRAULICS
- 1 C2022004-LUBRICATION - LUBRICATION
- 1 C2022004-DISTRIBUTION - DISTRIBUTION
- 1 C2022004-ELECTRICAL SYSTEMS - ELECTRICAL SYSTEMS
- 1 C2022004-HOPPER - HOPPER



Logistics

Our professional logistics team ensures that our machines and parts are packaged, supported, and handled with care and oversight to ensure secure and efficient transportation and container shipments.



After sale service and training

With the LEMKEN structures behind EQUALIZER, training programs and after-sales service will now graduate to industry-leading.

Equalizer suppliers

- Our machines are built with top-end partner suppliers and equipped with the latest technology.
- Equalizer planters come factory-fitted with **Precision Planting®** seed metering units.
- Equalizer is a member of **SSAB'S** My Inner strenx® program.



CII NARROW PLANTERS

- Robust high strength steel frame and row units made to work in tough conditions.
- Disc running with a leading and trailing configuration ensuring more carefree hectares.
- Disc angle is one of the smallest in the market ensuring an easy to close small furrow.
- Small disc angle also ensures less soil disturbance.
- Gauge wheels are trailed, for improved flotation in soft soil conditions.
- Gauge wheels are adjustable away from the discs, this aids unit flotation in soft soil conditions with scrapers cleaning the discs.
- 3 spoke gauge wheels allows soil and trash to clear out from within the wheel.
- Factory fitted with Precision Planting equipment.
- Separate fertilizer coulters with gauge wheel to apply fertilizer 50mm (2") to the side of the seed row.
- Frame lifts up high for easy maintenance from a standing position, no need to work on the floor.
- Large wheels for superior flotation.
- Narrow transport parameters of 3.5m (11.5ft) - 4.2m (13.8ft) wide by 3.5m (11.5ft) - 4.5m (14.8ft) tall.
- Equalizer offers flexibility with dry and liquid fertilizer application.
- On-frame tank which is factory fitted, and able to carry 3 different products.

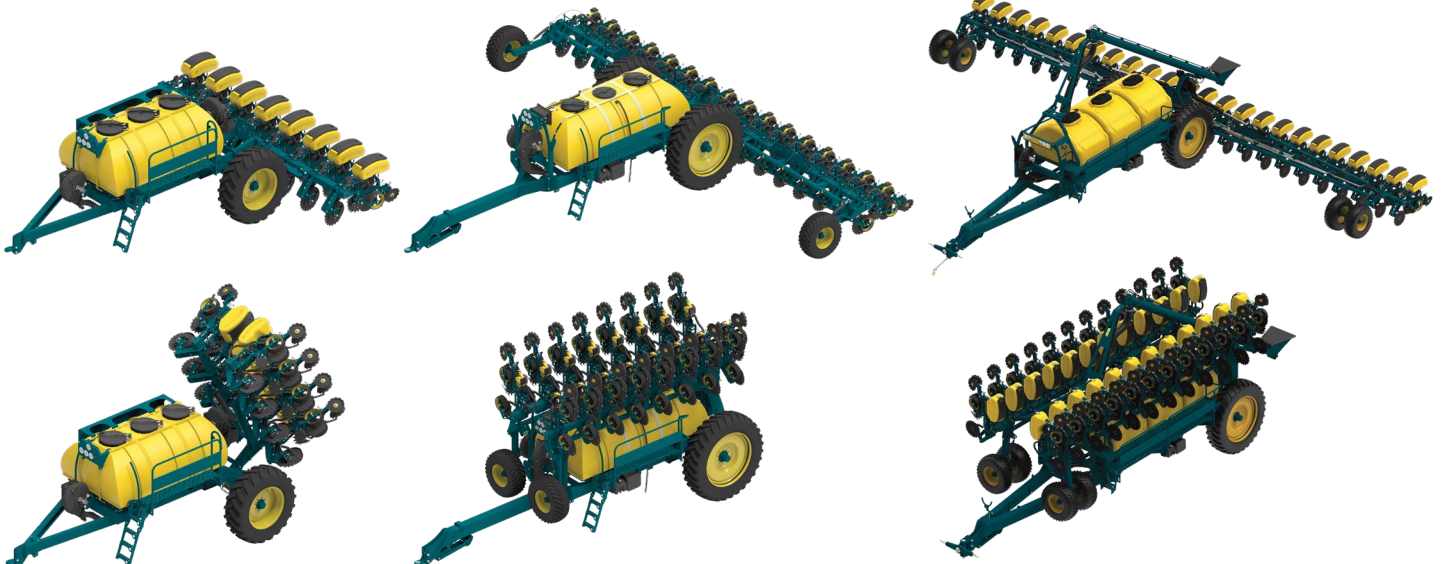

A conventional planter for crops such as corn, sunflower, and soya beans. Applicable for moderate no-till or un-prepared soil conditions.



RANGE	8/762N	8/914N	12/762N	12/914N	16/762N	16/914N	24/508N	24/762N
Number of Rows	8		12		16		24	24
Row Spacing (mm)(in)	762(30)	914(36)	762(30)	914(36)	762(30)	914(36)	508(20)	762(30)
Main Wheel Track Width (m)(ft)	3(9.8)			3.6(12)	3(9.8)	3.6(12)	3(9.8)	
Tractor Power Required (kw)(hp)	96(129)		144(193)		192(258)			288(386)
Frame Style	2 - Section vertical fold		2 - Section forward folding frame					
Hitch Style	Drawbar for CAT4 (2") or CAT5 (2.75") pin							
Working Width (m)(ft)	6.1(20)	7.3(24)	9.1(30)	11(36)	12.2(40)	14.6(48)	12.2(40)	18.3(60)
Transport Width (m)(ft)	3.5(11.5)	4.2(13.8)	3.5(11.5)	4.2(13.8)	3.7(12.1)	4.2(13.8)	3.7(12.1)	3.8(12.5)
Transport Height (m)(ft)	4.1(13.5)	4.7(15.4)	4.3(14.1)		4.1(13.5)			4.3(14.1)
Seed Hopper Volume per Row (l)(gal)	75(19.8)							
Fertilizer Hopper Volume (l)	3 Bin Total = 4750 (1550/1650/1550)			3 Bin Total = 7200 (2400/2400/2400)				3 Bin Total = 10200 (3400/3400/3400)
Fertilizer Hopper Volume (gal)	3 Bin Total = 1254 (409/436/409)			3 Bin Total = 1899 (633/633/633)				3 Bin Total = 2694 (898/898/898)

CII PRECISION UNIT

Large 75l (19.8 gal) seed hopper

Or mini hopper fed from central seed hopper tank.

Precision planting's vacuum seed meter

Factory fitted with vSet2 for effortless meter accuracy. More than 13 crop kits to handle almost any crop from maize and soya to canola and wheat.

Parallel arms

With easily adjustable mechanical spring downforce; or DeltaForce - variable row by row hydraulic downforce.

Precision planting vDrive

Electric with 20120 control system.

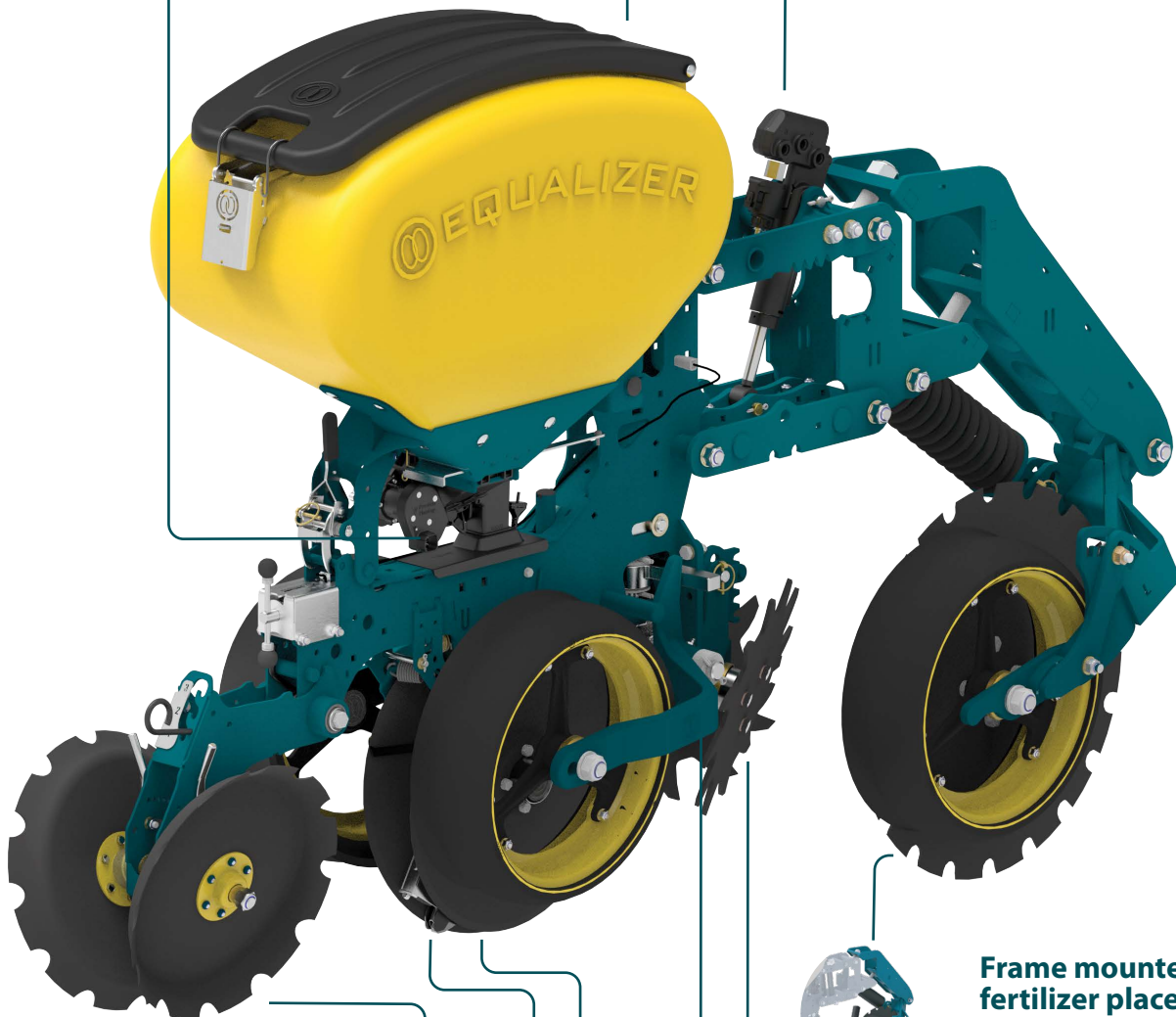

Notched steel wheels

With independent toe-out adjustment.

Optional seed firmers

SmartFirmer2 compatible quick attach bracket or Low Stick Keeton Seed Firmer with quick attach bracket.

Seed disc

Can be replaced without removing the hubs. 9.5 degree seed disc angle for less soil disturbance and better fuel efficiency.

Frame mounted fertilizer placement

508mm (20") angled notched fertilizer coulters with gauge wheel.

Residue management

Double row cleaners, with tool free adjustment.

Recessed gauge wheel arms

Reduce unit width and improve material flow.

PRODUCT PLACEMENT OPTIONS

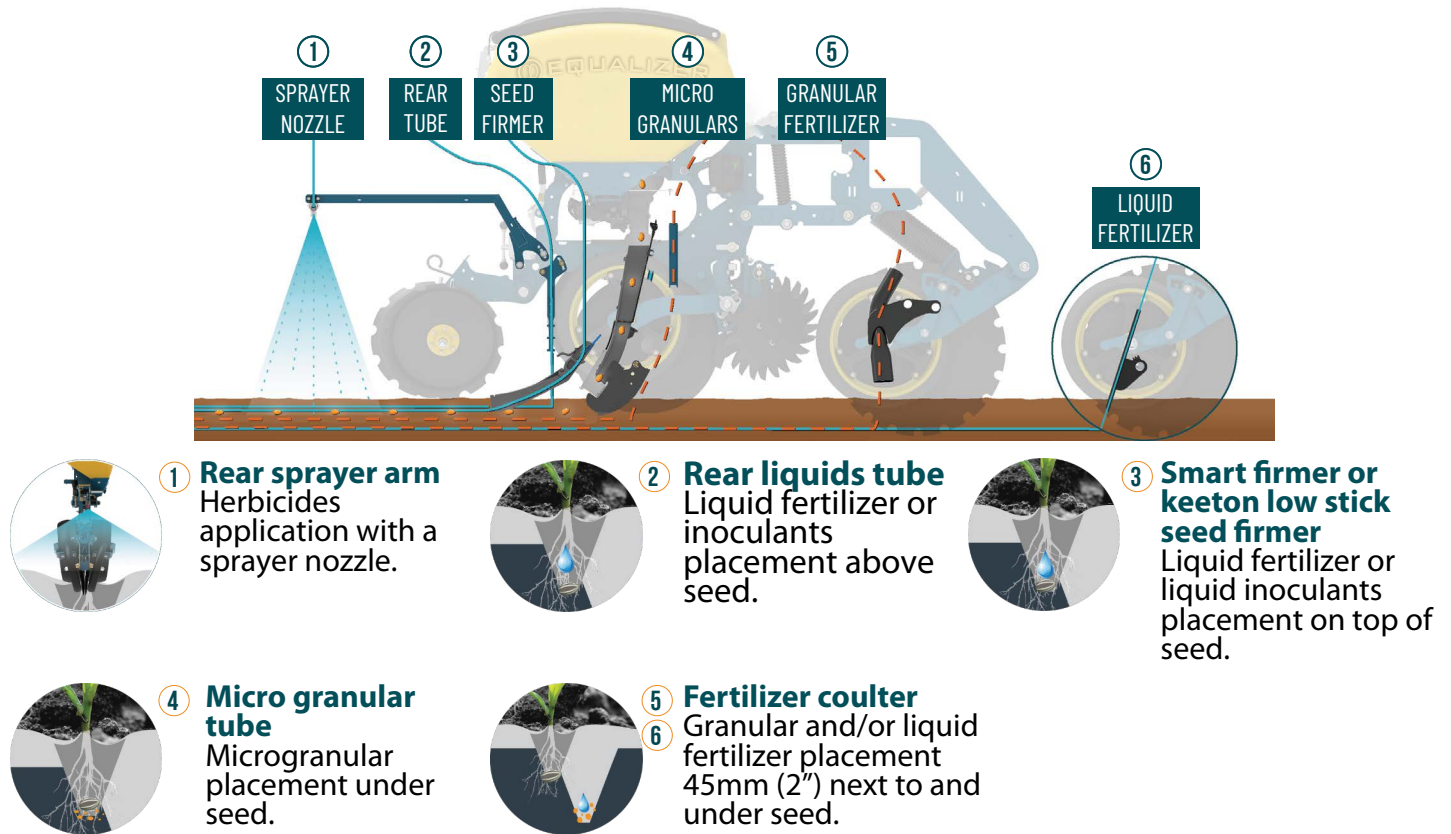

Seed and fertilizer distribution

- The polyethylene tanks are suitable for liquid as well as granular fertilizer.
- When equipped with liquid tanks, Banjo tank fittings, manifolds, valves and three-stage filters are standard.

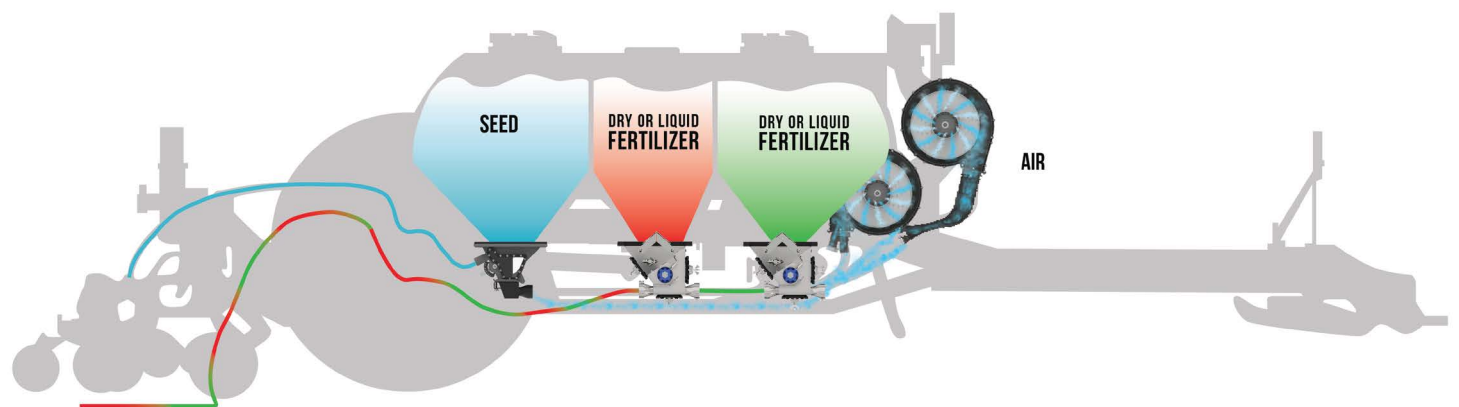

Granular fertilizer meter box

- Stainless steel with self-cleaning poly meter roller.
- Accurate, versatile, and simple with effortless calibration.
- One metering roller for all fertilizer and seed types and sizes.
- Direct fertilizer supply to each row for 8 - 16 row machines.

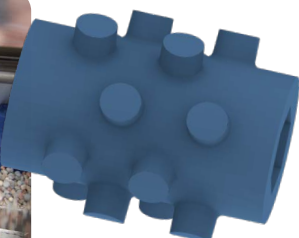

**NO ROLLER
CHANGES
REQUIRED**



CII ULTRA PLANTERS

- Robust high-strength steel frame and row units made to work in tough conditions.
- Coulter Discs running with a leading and trailing configuration ensuring longer maintenance-free operation.
- Disc angle is one of the smallest in the market ensuring a small easy-to-close furrow.
- A small disc angle also ensures less soil disturbance.
- Gauge wheels are trailed, for improved flotation.
- Gauge wheels are adjustable away from the discs, this aids unit flotation in soft soil conditions.
- Open 3-spoke gauge wheels allow soil and trash to clear out from within the wheel.
- Factory fitted with Precision Planting equipment.
- Separate fertilizer coultter with gauge wheel to apply fertilizer 50mm (2") to the side of the seed row.
- Large wheels or tracks for superior flotation.
- Transport parameters of 5m (16.4ft) wide by 5m (16.4ft) tall.
- Equalizer's modular 3 or 4-bin design gives you the flexibility to manage seed and fertilizer combinations, which could consist of granular or liquid products, depending on your farming requirements.



This is our flagship planter used to plant row crops like corn, sunflower, soya beans, etc.



RANGE	24/914U	32/762U	36/508U
Number of Rows	24	32	36
Row Spacing (mm)(in)	914(36)	762(30)	508(20)
Main Wheel Track Width (m)(ft)	3.6(12)	3(9.8)	3(9.8)
Tractor Power Required (kw)(hp)	288(386)	384(515)	432(580)
Frame Style	3 - Section forward folding frame		
Hitch Style	CAT4 - 3 point linkage		
Working Width (m)(ft)	22(72)	24.4(80)	18.3(60)
Transport Width (m)(ft)	5(16.4)		
Transport Height (m)(ft)	5(16.4)		
Seed Hopper Volume per Row (l)(gal)	75(19.8)		
Fertilizer Hopper Volume (l)	3 Bin Total = 6150 (2250/1650/2250)	OR	4 Bin Total = 7800 (2250/1650/1650/2250)
Fertilizer Hopper Volume (gal)	3 Bin Total = 1624 (594/436/594)	OR	4 Bin Total = 2060 (594/436/436/594)

CII PRECISION UNIT

Large 75l (19.8 gal) seed hopper

Or mini hopper fed from central seed hopper tank.

Precision planting's vacuum seed meter

Factory fitted with vSet2 for effortless meter accuracy. More than 13 crop kits to handle almost any crop from maize and soya to canola and wheat.

Parallel arms

With easily adjustable mechanical spring downforce; or DeltaForce - variable row by row hydraulic downforce.

Precision planting vDrive

Electric with 20120 control system.

Notched steel wheels

With independent toe-out adjustment.

Optional seed firmers

SmartFirmer2 compatible quick attach bracket or Low Stick Keeton Seed Firmer with quick attach bracket.

Seed disc

Can be replaced without removing the hubs. 9.5 degree seed disc angle for less soil disturbance and better fuel efficiency.

Frame mounted fertilizer placement

508mm (20") angled notched fertilizer coulters with gauge wheel.

Residue management

Double row cleaners, with tool free adjustment.

Recessed gauge wheel arms

Reduce unit width and improve material flow.

PRODUCT PLACEMENT OPTIONS

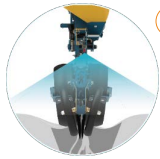
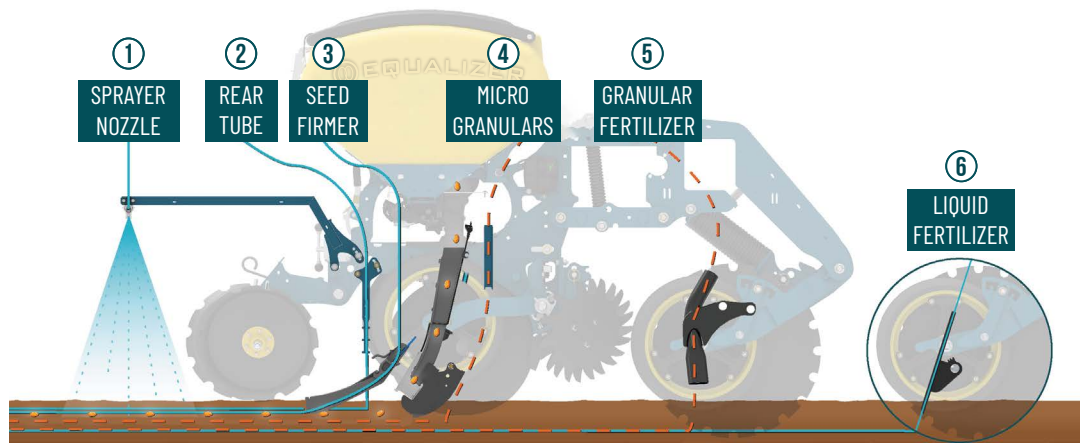

- ① **Rear sprayer arm**
Herbicides application with a spray nozzle.



- ② **Rear liquids tube**
Liquid fertilizer or inoculants placement above seed.



- ③ **Smart firmer or keeton low stick seed firmer**
Liquid fertilizer or liquid inoculants placement on top of seed.



- ④ **Micro granular tube**
Microgranular placement under seed.



- ⑤ **Fertilizer coulter**
Granular and/or liquid fertilizer placement 45mm (2") next to and under seed.

Seed and fertilizer distribution

- The polyethylene tanks are suitable for liquid as well as granular fertilizer.
- When equipped with liquid tanks, Banjo tank fittings, manifolds, valves and three-stage filters are standard.

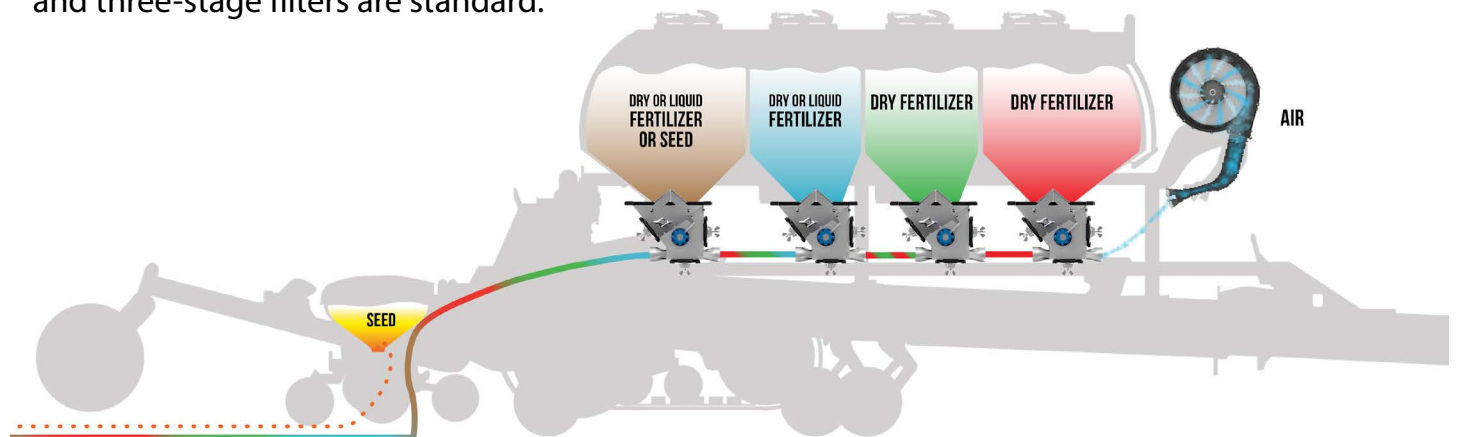

Granular fertilizer meter box

- Stainless steel with self-cleaning poly meter roller.
- Accurate, versatile, and simple with effortless calibration.
- One metering roller for all fertilizer and seed types and sizes.
- Direct fertilizer supply to each row for 8 - 16 row machines.

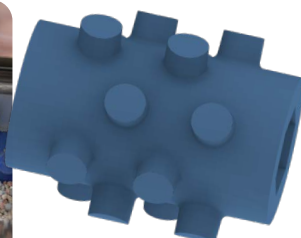

**NO ROLLER
CHANGES
REQUIRED**

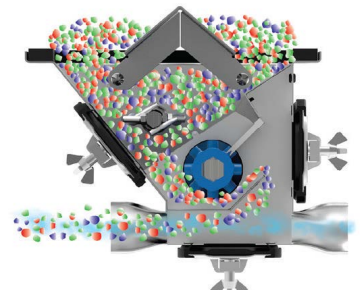

SLII NARROW PLANTERS

- Robust high-strength steel frame and row units made to work in tough conditions.
- Coulter Discs running with a leading and trailing configuration ensuring longer maintenance-free operation.
- Disc angle is one of the smallest in the market ensuring a small easy-to-close furrow.
- A small disc angle also ensures less soil disturbance.
- Gauge wheels are trailed, for improved floatation.
- Gauge wheels are adjustable away from the seed discs, this aids unit flotation and less sidewall compaction.
- Open 3-spoke gauge wheels allow soil and debris to clear out from within the wheel.
- Factory fitted with Precision Planting equipment.
- Unique semi-independent tine and seeding system allows the hydraulic downforce tine with dampened reset to clear smaller obstacles without disrupting the seed placement.
- The fertilizer tine unit and seed placement float on the same parallel linkage which ensures a consistent seed to fertilizer relationship.
- Unique on-unit fertilizer placed at a 45mm (1.8") offset at the tines, for consistent depth between seed and fertilizer placement.
- Frame lifts high for easy maintenance from a standing position, no need to work on the floor.
- Large 480/80R50 main-frame wheels for superior floatation.
- Narrow transport parameters of 3.5m (11.5ft) - 4.2m (13.8ft) wide by 4.8m (15.8ft) tall.
- Equalizer's modular 3-bin design gives you the flexibility to manage seed and fertilizer combinations, which could consist of granular or liquid products, depending on your farming requirements.

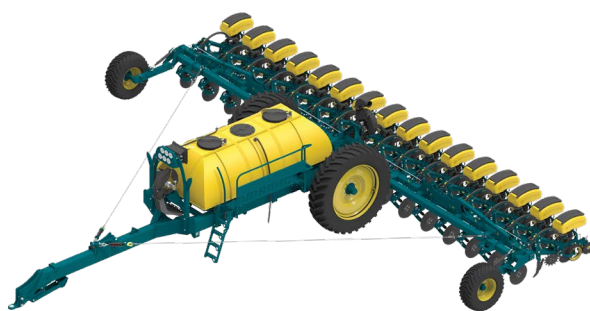

Designed for both minimal or reduced tillage, ideal for seeding of most row crops.



RANGE	*8/762	*8/914	12/762N	12/914N	16/762N	16/914N
Number of Rows	8	8	12	12	16	16
Row Spacing (mm)(in)	762(30)	914(36)	762(30)	914(36)	762(30)	914(36)
Main Wheel Track Width(m)(ft)	3(9.8)	3.6(12)	3(9.8)	3.6(12)	3(9.8)	3.6(12)
Tractor Power Required (kw)(hp)	120(161)	120(161)	180(241)	180(241)	240(321)	240(321)
Frame Style	3 - Section vertical folding frame		2 - Section forward folding frame			
Hitch Style	Drawbar for CAT3 (1.5")		Drawbar with hardened insert for CAT3 (1.5") or CAT4 (2") or CAT5 (2.75") pin			
Working Width (m)(ft)	6.1(20)	7.3(24)	9.1(30)	11(36)	12.2(40)	14.6(48)
Transport Width (m)(ft)	5.3(17.4)		3.5(11.5)	4.2(13.8)	3.8(12.5)	4.2(13.8)
Transport Height (m)(ft)	3.5(11.5)	4.2(13.8)	4.8(15.8)		4.6(15.1)	
Seed Hopper Volume per Row (l)(gal)	75(19.8)					
Fertilizer Hopper Volume (l)	3 Bin Total = 4750 (1550/1650/1550)			3 Bin Total = 6150 (2250/1650/2250)	3 Bin Total = 7200 (2400/2400/2400)	
Fertilizer Hopper Volume (gal)	3 Bin Total = 1254 (409/436/409)			3 Bin Total = 1624 (594/436/495)	3 Bin Total = 1899 (633/633/633)	
* Not available in the Narrow model, but is available in the vertical fold model						

SLII PRECISION UNIT

Large 75l (19.8 gal) seed hopper

Or mini hopper fed from central seed hopper tank.

Precision planting's vacuum seed meter

Factory fitted with vSet2 for effortless meter accuracy. More than 13 crop kits to handle almost any crop from maize and soya to canola and wheat.

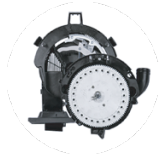

Delta force

Or easy adjustable mechanical down force mechanism.



Precision planting vDrive

Electric with 20I20 control system.

Frame mounted residue couler

508mm (20") couler fitted on the frame in front of the unit.

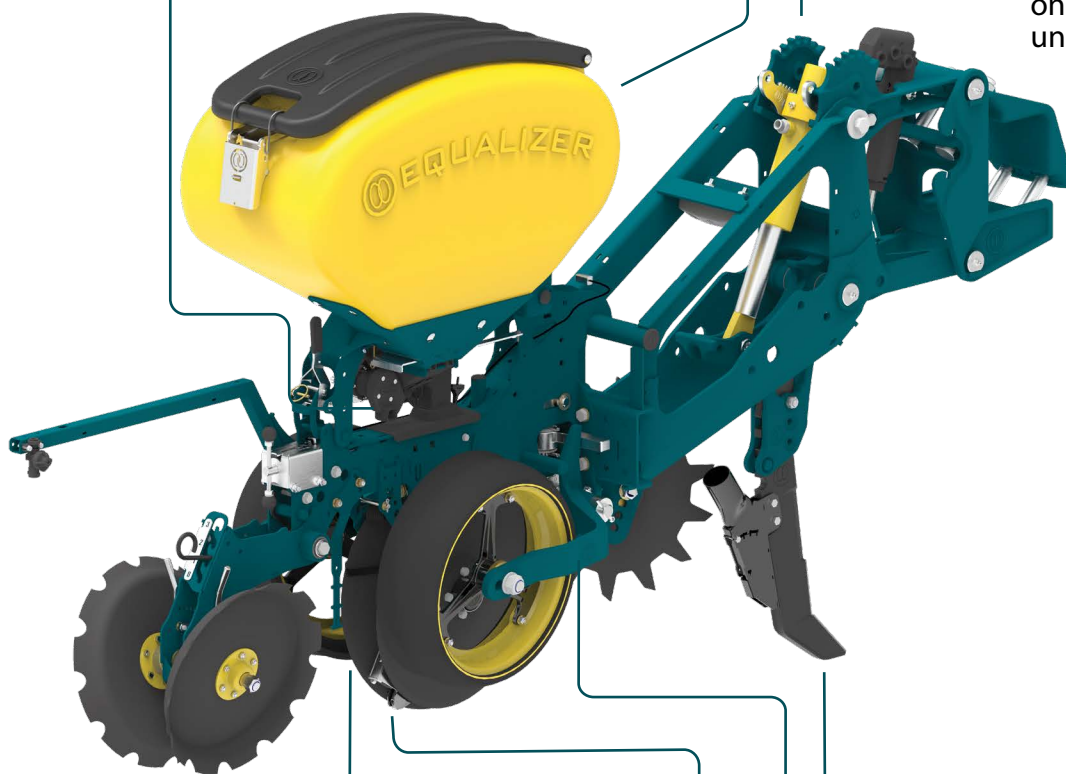
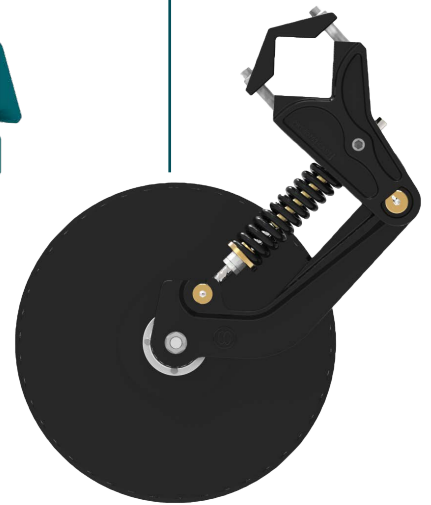

Notched steel wheels

With independent toe-out adjustment.



Seed disc

Can be replaced without removing the hub. 9.5 degree seed disc angle for less soil disturbance and better fuel efficiency.



Optional seed firmers

SmartFirmer2 compatible quick attach bracket or Low Stick Keeton Seed Firmer with quick attach bracket.



Shear Options:



16mm ($\frac{3}{8}$ ") Knife point shear

For extra durability and prolonged wear life.



16mm ($\frac{3}{8}$ ") Aerator shear

For more aggressive aeration of the soil.

Recessed gauge wheel arms

Reduce unit width and improve material flow.

PRODUCT PLACEMENT OPTIONS

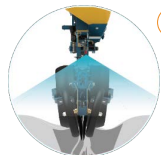
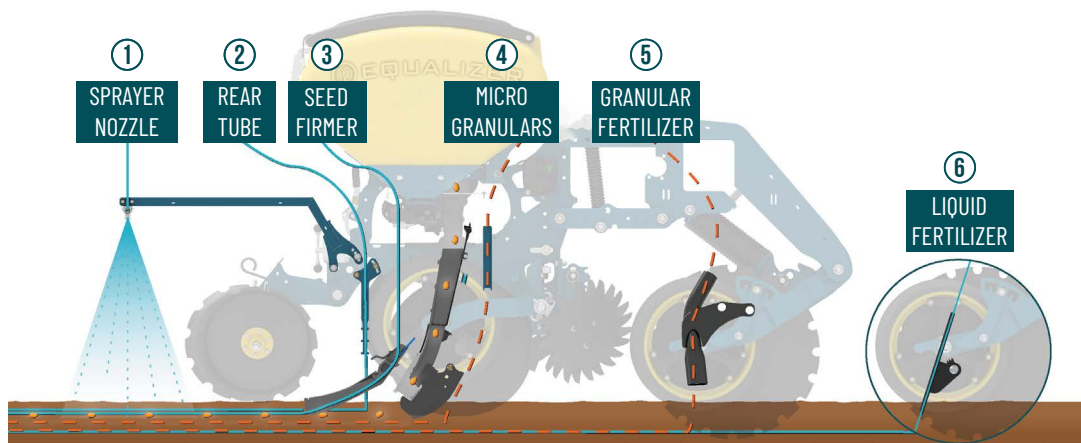

- 1 Rear sprayer arm**
Herbicides application with a sprayer nozzle.



- 2 Rear liquids tube**
Liquid fertilizer or inoculants placement above seed.



- 3 Smart firmer or keeton low stick seed firmer**
Liquid fertilizer or liquid inoculants placement on top of seed.

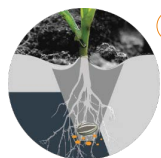

- 4 Micro granular tube**
Microgranular placement under seed.



- 5 Fertilizer coulter**
6 Granular and/or liquid fertilizer placement 45mm (2") next to and under seed.

Seed and fertilizer distribution

- The polyethylene tanks are suitable for liquid as well as granular fertilizer.
- When equipped with liquid tanks, Banjo tank fittings, manifolds, valves and three-stage filters are standard.

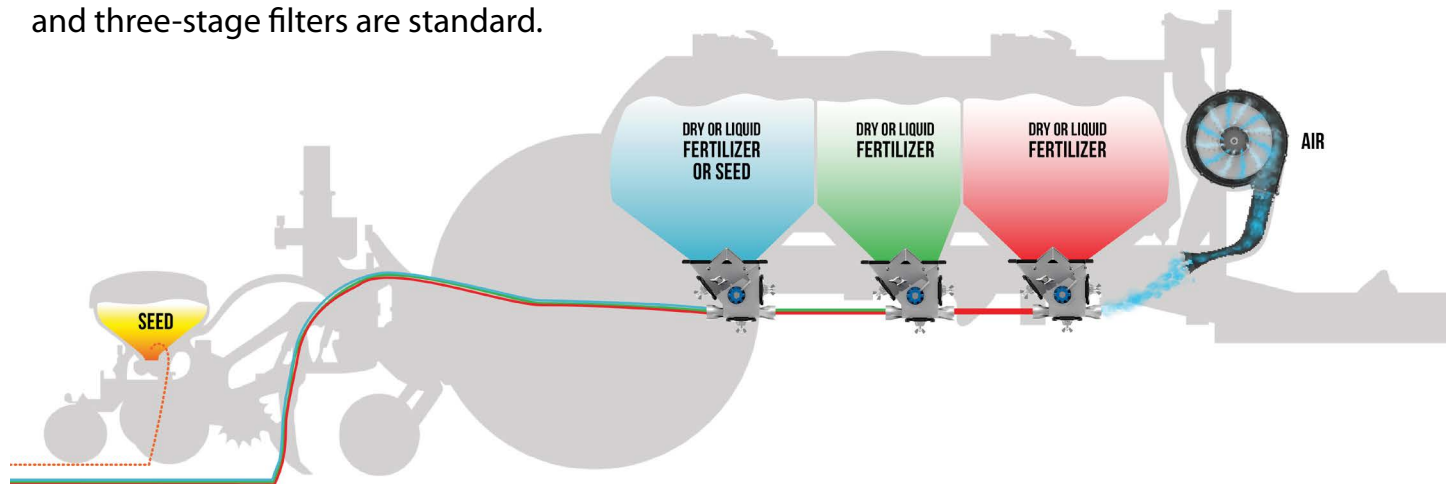

Granular fertilizer meter box

- Stainless steel with self-cleaning poly meter roller.
- Accurate, versatile, and simple with effortless calibration.
- One metering roller for all fertilizer and seed types and sizes.
- Direct fertilizer supply to each row for 8 - 16 row machines.

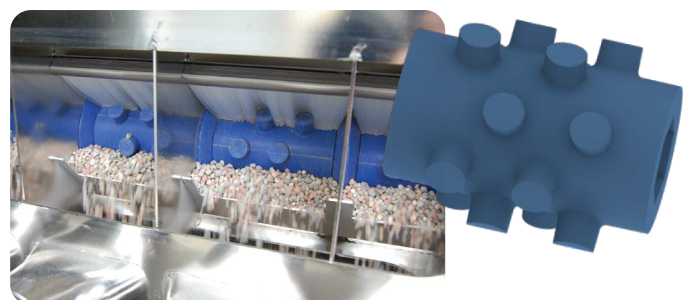

NO ROLLER CHANGES REQUIRED

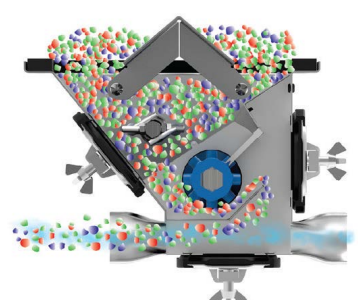

TINE SEEDERS



- Digging ability when deeper cultivation is required.
- Break-out force of 450kg (992lbs).
- Semi-independent row unit trip.
- Quick seed depth adjustment without any tools.
- Frame lifts very high for easy access to the row units.
- Ability to fit an on-frame liquid tank.
- 3m (120") main wheel track.
- Forward positioned wing wheels add stability in hard soils.
- Closed circuit hydraulic down force system (no constant flow hydraulics).

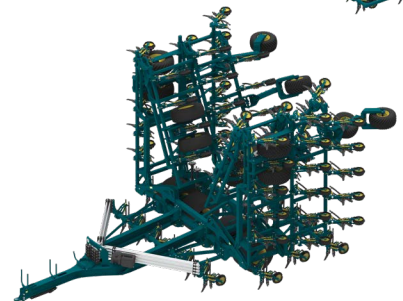
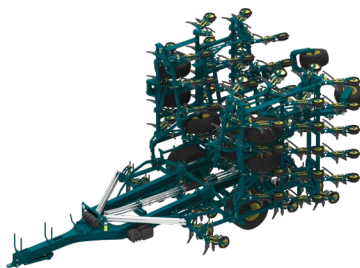
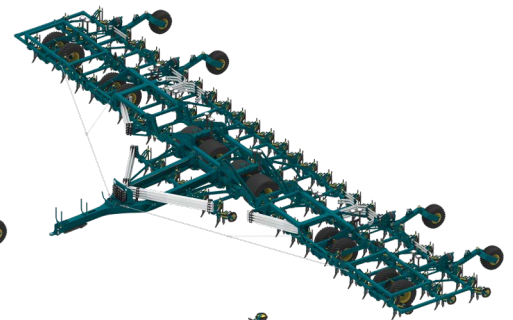
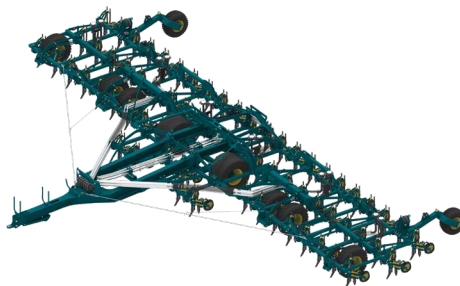
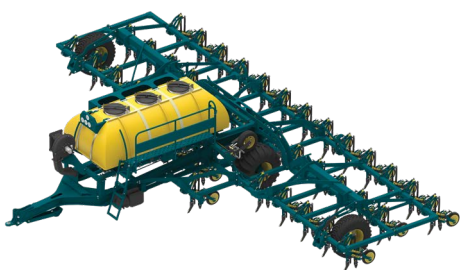

Designed for both minimal or reduced tillage, ideal for seeding of all small grains.



RANGE	12 000V		15 000VX		18 000VX		24 000VX
Number of Rows	40	44	50	54	60	66	80
Row Spacing (mm)(in)	300(11.8)	273(10.7)	300(11.8)	273(10.7)	300(11.8)	273(10.7)	300(11.8)
Main Wheel Track Width (m)(ft)	3(9.8)						1.8(5.9)(In) 4.2(13.8)(Out)
Tractor Power Required (kw)(hp)	246(320)	270(352)	308(400)	332(432)	370(480)	406(528)	492(640)
Frame Style	3 - Section vertical folding frame		5 - Section narrow transport vertical folding frame				
Hitch Style	Drawbar with hardened insert for CAT3 (1.5") or CAT4 (2") or CAT5 (2.75") pin						
Working Width (m)(ft)	12(39.4)		15(49.2)	14.8(48.6)	18(59)		24(78.7)
Transport Width (m)(ft)	6(19.7)						7.8(25.6)
Transport Height (m)(ft)	5.2(17.1)		5(16.4)				6.3(20.7)
Fertilizer Hopper Volume (l)	3 Bin Total = 6150(2250/1650/2250)		2 Bin Total = 4500(2250/2250)				N/A
Fertilizer Hopper Volume (gal)	3 Bin Total = 1624(594/436/594)		2 Bin Total = 1188(594/594)				N/A
Unique Frame Features	• Optional fixed frame mounted auger • Optional central fine seed or pesticide tank						

TINE SEEDER UNIT

Quick depth adjustment

Easy depth adjustment clip.
No tools required.

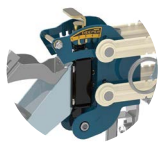

Optional press wheel scraper

To remove mud build-up in
sticky conditions.



Closing Wheel Options:

Narrow semi-pneumatic press wheel

Works well in rocky and
most other conditions.



Wide equalizer press wheel

Works well in very soft
and sandy conditions.



Wide fork for aftermarket wheel

Fork, bolt and spacers for
when a unique aftermarket
wheel is required.



Shear Options:



16mm ($\frac{3}{8}$ ") knife point

For extra durability and
prolonged wear life.



Narrow 10mm ($\frac{3}{8}$ ") knife point

Reduced or minimal soil
disturbance.

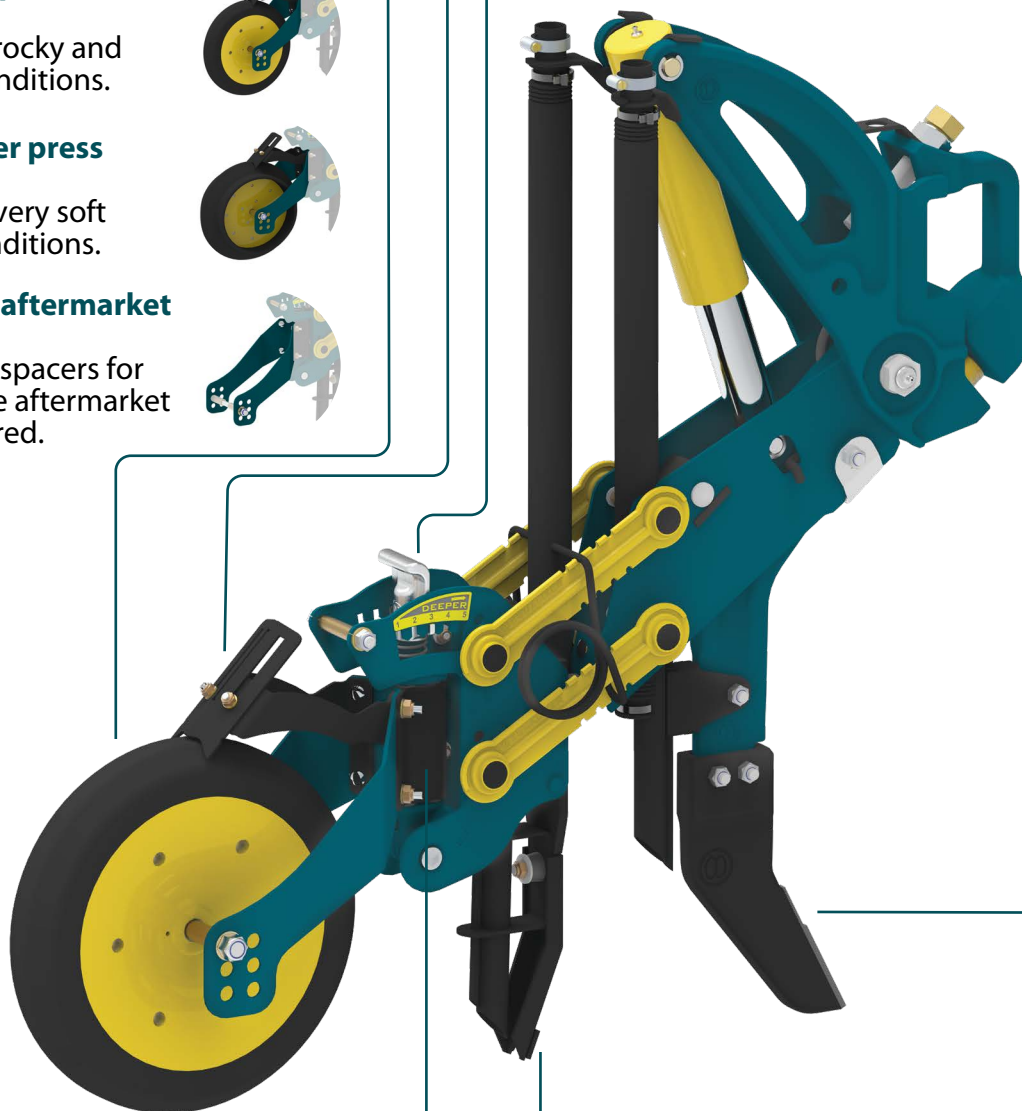

Seeding Boot Options:

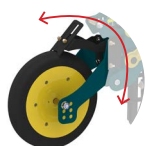

Press wheel lateral hinge

Allows slight lateral movement to
follow furrow around contours.



Standard single chute

Seed depth 5-50mm ($\frac{1}{4}$ " - 2")
Seed band width 30mm ($1\frac{1}{4}$ ")



Double chute

Seed depth 5-30mm ($\frac{1}{4}$ " - $1\frac{1}{4}$ ")
Seed band width 60mm ($2\frac{1}{4}$ ")

INDEPENDENT FERTILIZER & SEED PLACEMENT

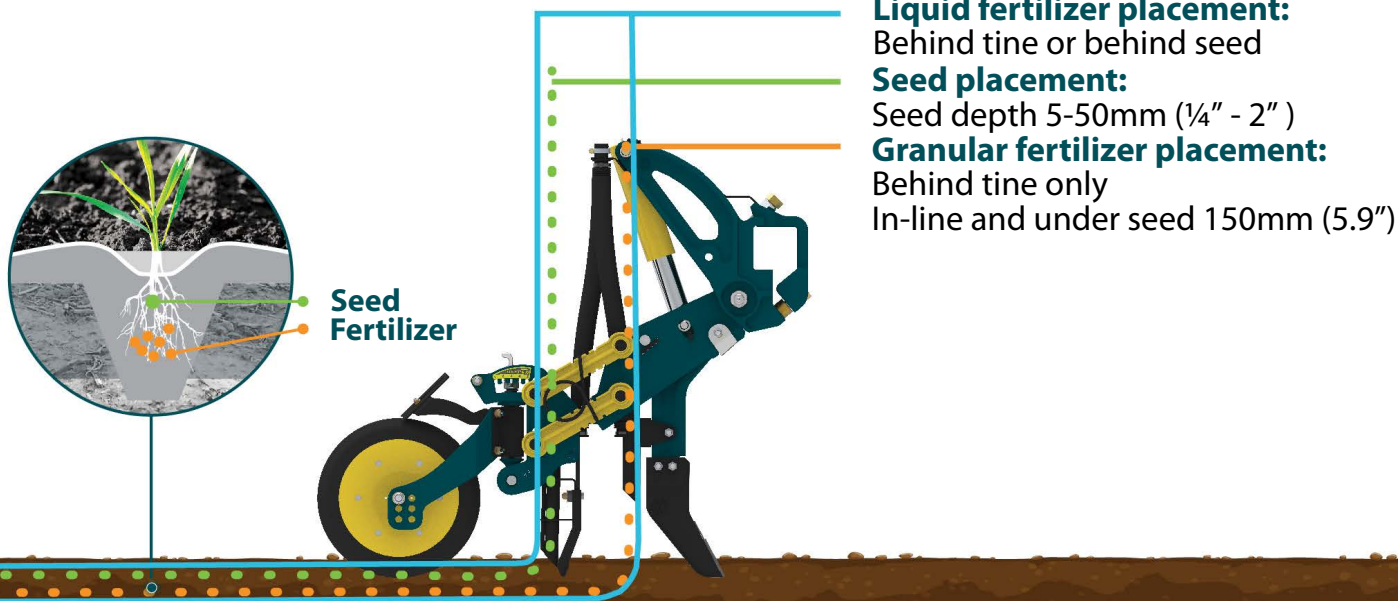

Optional hydraulic residue couler

- Hydraulic cylinder for superior residue-cutting ability.
- Hydraulic downforce with easy downforce adjustment, with a maximum downforce of 300kg (660lb).
- Hydraulic raise and store of coulters when not in use.
- 560mm (22") large cutting disc.
- No maintenance, sealed SKF agri hub bearing.
- Allows for lateral swing.

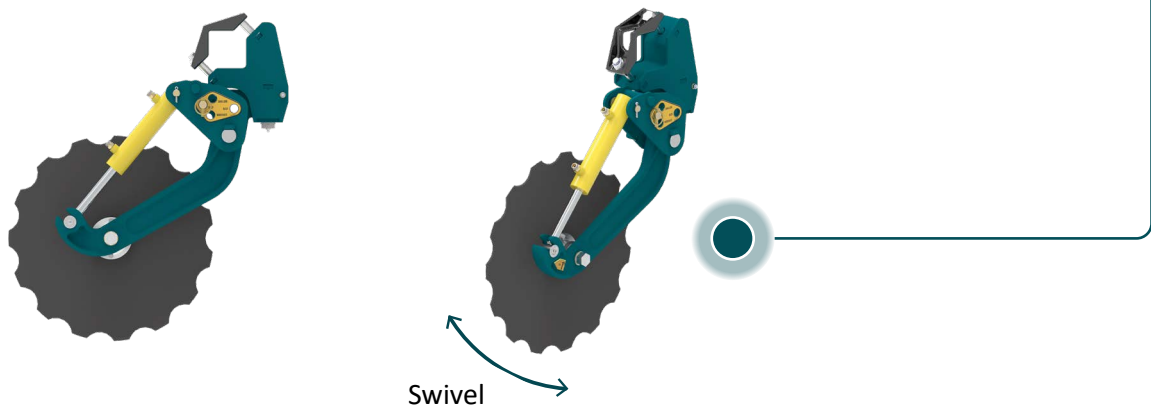

Closed circuit hydraulic trip action

When a large obstacle is encountered, the unit as a whole will trip and clear the obstacle to avoid damage to the unit. To further protect the unit, the hydraulic cylinder is equipped with a built-in dampener, allowing controlled return of the tine after tripping.

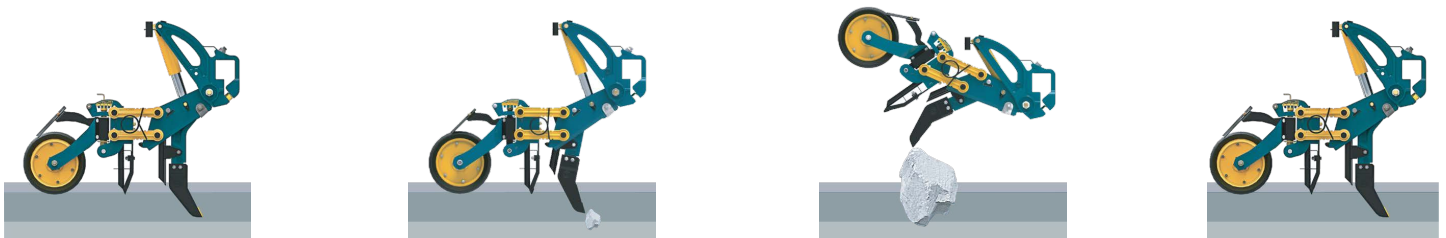

VT DISC SEEDERS

- Narrow transport width 3.5m (11.5ft).
- 3m (120") main wheel track.
- Large wheels for less soil compaction and superior flotation (providing the ability to continue planting in softer soil conditions where smaller wheels tend to bulldoze or create compaction layers).
- Tilting of the machine when lifting provides easy access to the row units for maintenance.
- Active wing downforce via a closed loop system with an accumulator, no constant flow hydraulics.
- Forward positioned wing wheels add stability in the wings in varying soil conditions.
- 3 on-frame tanks with a total volume of 6 150L (1 625gal) which can be set up for either liquid or granular product.
- Parallel seed boot mount for superior seed depth placement by keeping the seed boot parallel to the ground. This ensures consistent seed placement depth across the entire breakaway range, crucial for achieving uniform crop emergence and optimal yield.
- Standard seed brake that releases excess air pressure to allow for optimum air and seed flow, resulting in consistent seed placement and reduced seed bounce in furrow.
- Large gauge wheel for the best possible row unit flotation in softer soil conditions and for more consistency in seeding depth with varying soil conditions.
- Sharp edged steel closing wheel with notches for excellent closing ability in higher clay soils providing a cut and press action.

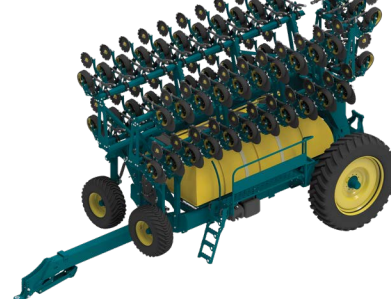
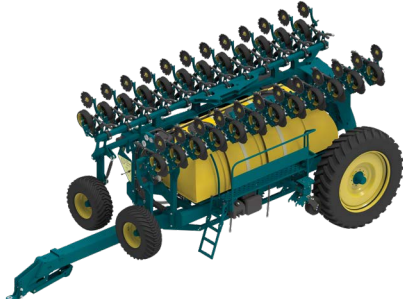
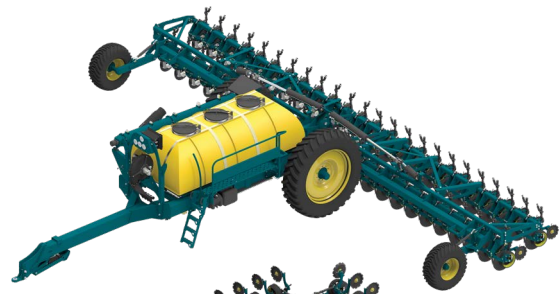
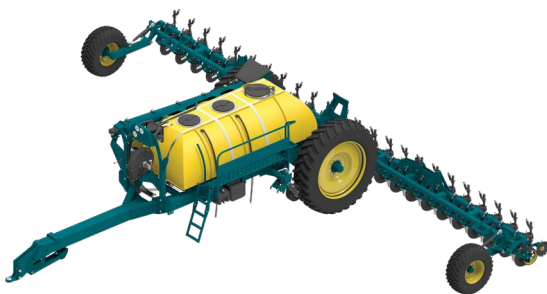

Ideal for seeding of small grains as well as soya beans on prepared (pre-tilled) soils but also moderate to soft unprepared (no-till) soils.



RANGE	12 000VT - 508	12 000VT - 254
Number of Rows	24	48
Row Spacing (mm)(in)	508(20)	254(10)
Main Wheel Track Width (m)(ft)	3(9.8)	
Tractor Power Required (kw)(hp)	192(260)	192(260)
Frame Style	2 - Section forward folding frame	3 - Section forward folding frame
Hitch Style	Drawbar for CAT4 (2") or CAT5 (2.75") pin	
Working Width (m)(ft)	12.2(40)	
Transport Width (m)(ft)	3.5(11.5)	
Transport Height (m)(ft)	3.7(12.1)	4.7(15.4)
Fertilizer Hopper Total Value (l)	3 Bin Total = 6 150(2 250/1 650/2 250)	
Fertilizer Hopper Total Value (g)	3 Bin Total = 1 624(594/436/594)	
Unique Frame Features	Narrow folding frame for easy transport	

VT DISC SEEDER UNIT

Quick adjust seed depth setting

Seed and fertilizer depth placement = 16 increments, 5-80mm (¼"-3") depending on soil type.

Gauge wheel

Large gauge wheel combined with spring downforce with very flat force curve for superior flotation.

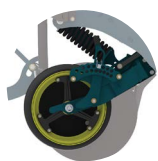

Seed brake

Releases excess air to allow for optimum air and seed flow, resulting in consistent seed placement.



Quick downforce adjustment

No tools required.

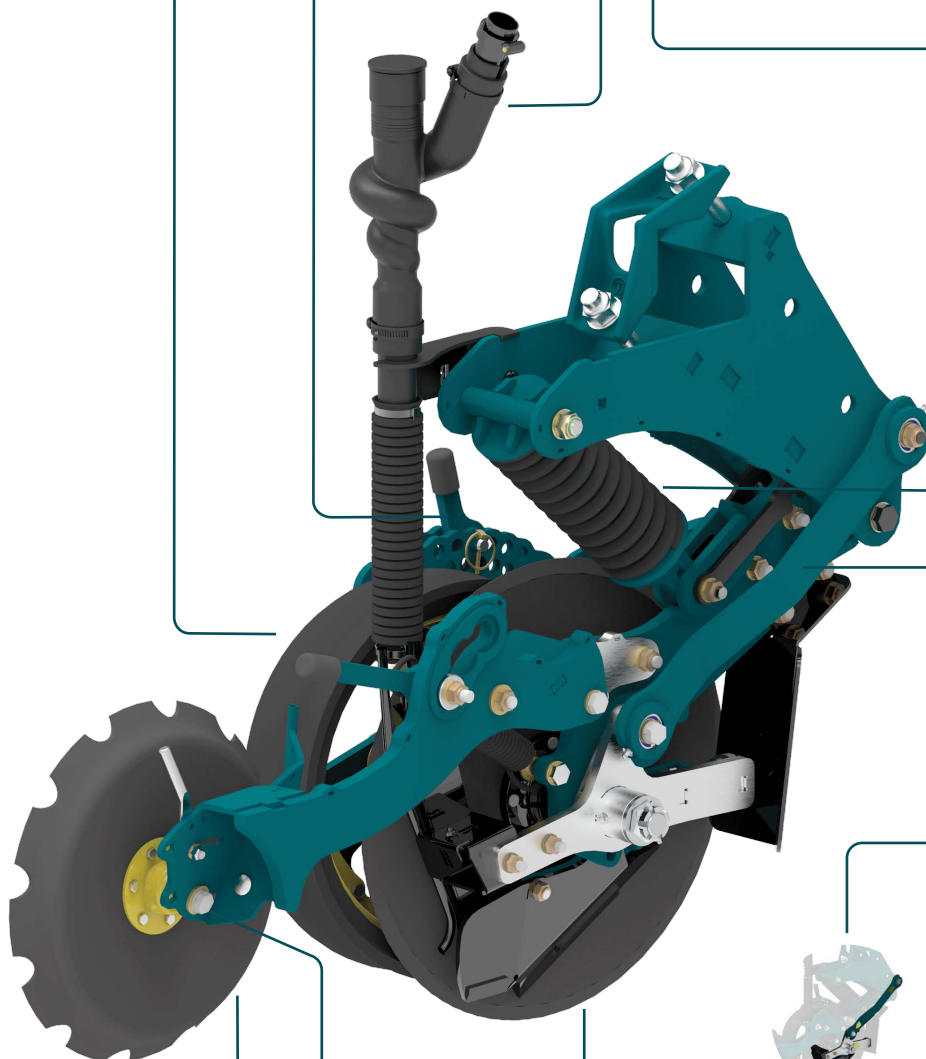

Single closing wheel

Works well in most conditions. Superior in tougher no-till conditions.

Optional closing wheel scraper

To remove mud build up in sticky conditions.



Parallel arm

Keeps the seed boot parallel to the ground.

Coulter Options:

457mm (18") Coulter

For tougher soils and seed placement up to 50mm (2") deep.

508mm (20") Coulter

For looser soils and/or where deep seed placement is required.

UNIQUE FERTILIZER & SEED PLACEMENT

Unique features

- Unique parallel arm to keep the seed boot parallel to the ground.
- This prevents seeds from shooting out the furrow when the unit floats or partially breaks away.

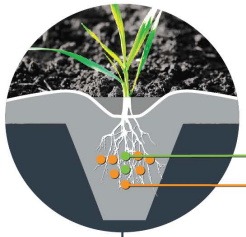

Seed Fertilizer

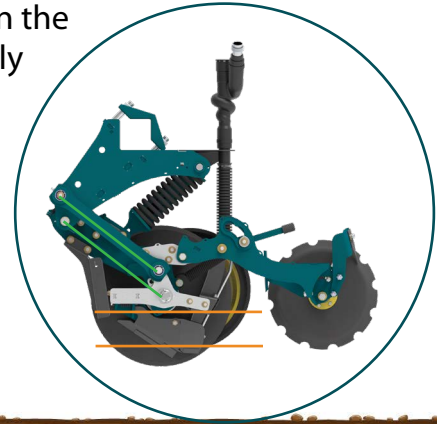
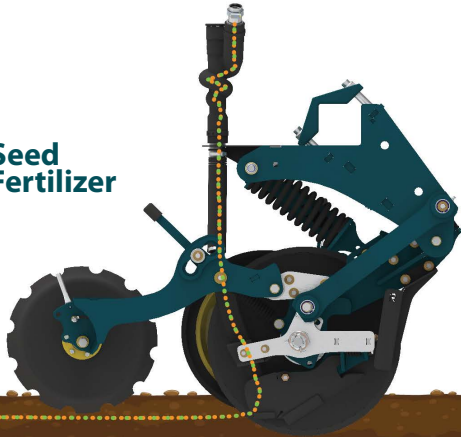

Seed and fertilizer distribution

- The polyethylene tanks are suitable for liquid as well as granular fertilizer.
- When equipped with liquid tanks, Banjo tank fittings, manifolds, valves and three-stage filters are standard.

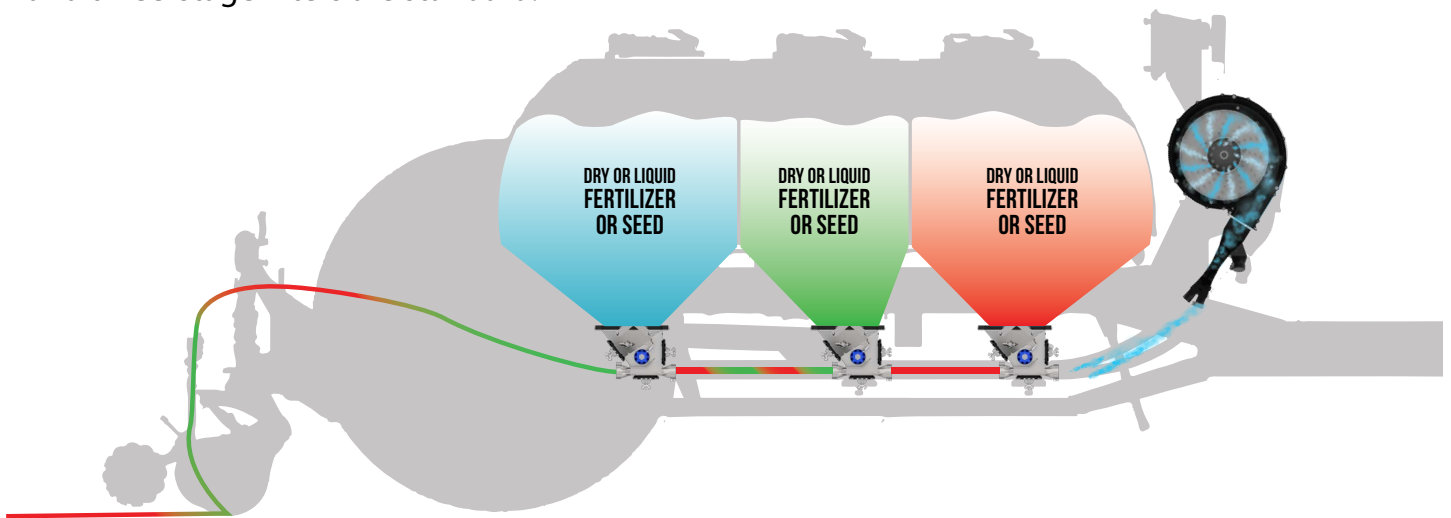

Granular fertilizer meter box

- Stainless steel with self-cleaning poly meter roller.
- Accurate, versatile, and simple with effortless calibration.
- One metering roller for all fertilizer and seed types and sizes.
- Direct fertilizer supply to each row for 8 - 16 row machines.

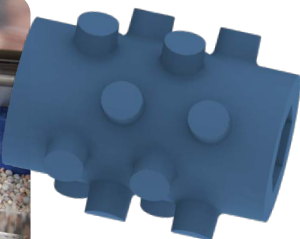

**NO ROLLER
CHANGES
REQUIRED**



TOW BETWEEN AND TOW BEHIND AIR CARTS



- Fitted with plastic tanks for liquid or granular product, depending on the configuration.
- Individual tanks scales for optimum control over application.
- Auger with full hydraulic control for movement via a remote.
- Twin fans factory fitted with air dryer (oil coolers).
- Individual line metering units feeding directly into secondary divider heads for more accurate distribution.
- Strong chassis with good weight distribution to manage drawbar load on the tractor.
- Comfortable and secure walkways fitted with fibre reinforced mesh with added grip to ensure the walkway does not get slippery because of dust and/or product spillage.
- Hydraulic drive meters which is able to integrate with multiple rate controllers.
- LED lighting package.
- 3m (120") wheel track running large single tyres that will integrate with most CTF (Controlled Traffic Farming) systems.
- Integrated anti product dumping system to balance air pressure in the tanks.

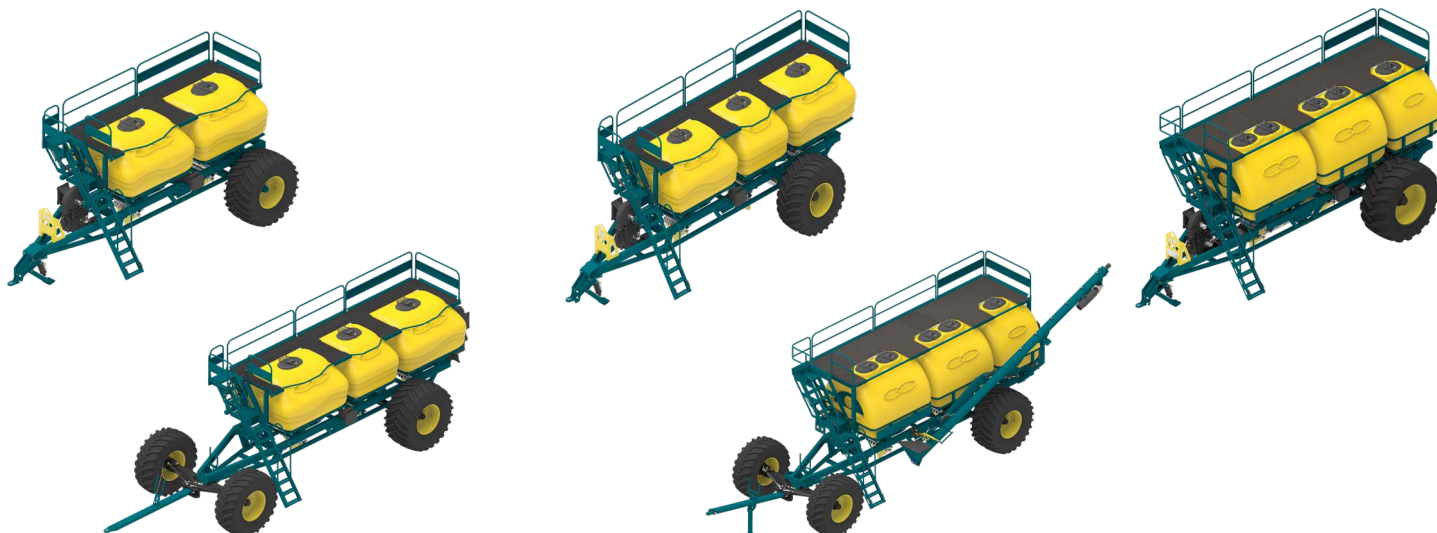

To work in conjunction with seeder bars (tine or disc) by carrying and distributing seed and fertilizer to the row units on the toolbars.



RANGE	12 000M2	16 000M3	22 000M3	16 000R3	22 000R3
Frame Style	Tow Between			Tow Behind	
Number of Bins	2	3			
Bin Capacity (l)(gal)	12000(3170)	16000(4227)	22000(5812)	16000(4227)	22000(5283)
Bin Configuration (l)	6000/6000	6000/4000/6000	8000/8000/6000	6000/4000/6000	8000/8000/6000
Bin Configuration (gal)	1585/1585	1585/1057/1585	2113/2113/1585	1585/1057/1585	2113/2113/1585
Main Wheel Track Width (m)(ft)	3(9.8)				
Hitch Style	Drawbar with hardened insert for CAT3 (1.5") or CAT4 (2") or CAT5 (2.75") pin				
Transport Width (m)(ft)	3.85(12.6) Main wheel option dependent				
Transport Height (m)(ft)	4.2(13.8)				

AIR CART FEATURES

Ladder and platform

Sturdy and comfortable ladder and platform.

Optional extra

Auger with hydraulically operated swing arm with remote control.

Plastic bins

- 8 000L (230bu), 6 000L (170bu), and 4 000L (114bu)
- 6 000L (1 600gal) and 4 000L (1 050gal) bins can accommodate liquid product.

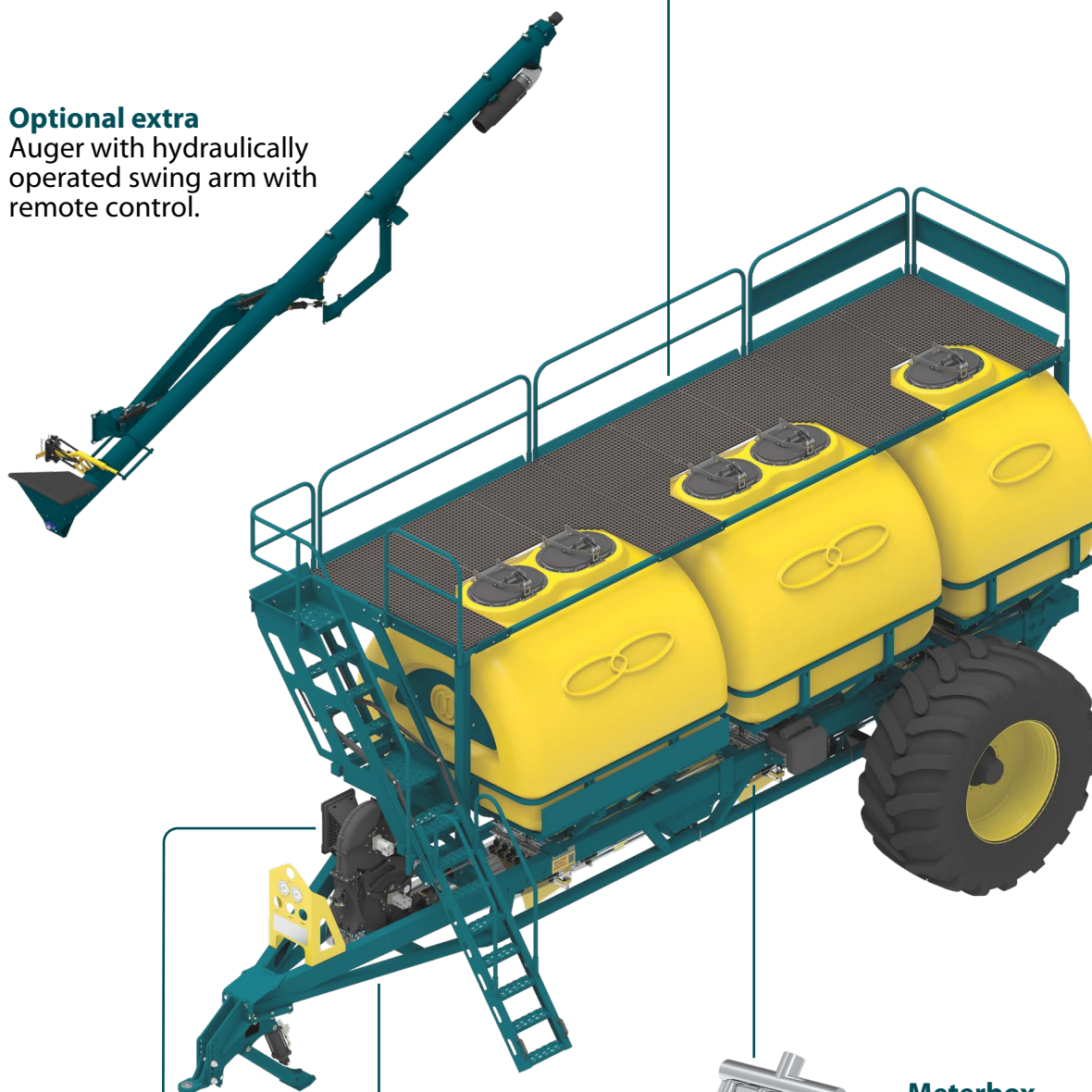

Centrifugal fan

- High performance centrifugal fan with low oil flow demand (50L/min, 13.2gal/min)
- Single or dual fan configuration.
- 2nd fan for double shoot distribution.

Meterbox

- Self-cleaning metering units for consistent product delivery.
- Low maintenance metering unit - No lubrication points.

Individual air lines

- Individual 63mm (2.5") air lines to each section.
- Or with dual shoot mixer meterbox attachment.

Chassis

Strong heavy duty chassis.

Seed and fertilizer distribution

- The polyethylene tanks are suitable for liquid as well as granular fertilizer.
- When equipped with liquid tanks, Banjo tank fittings, manifolds, valves and three-stage filters are standard.

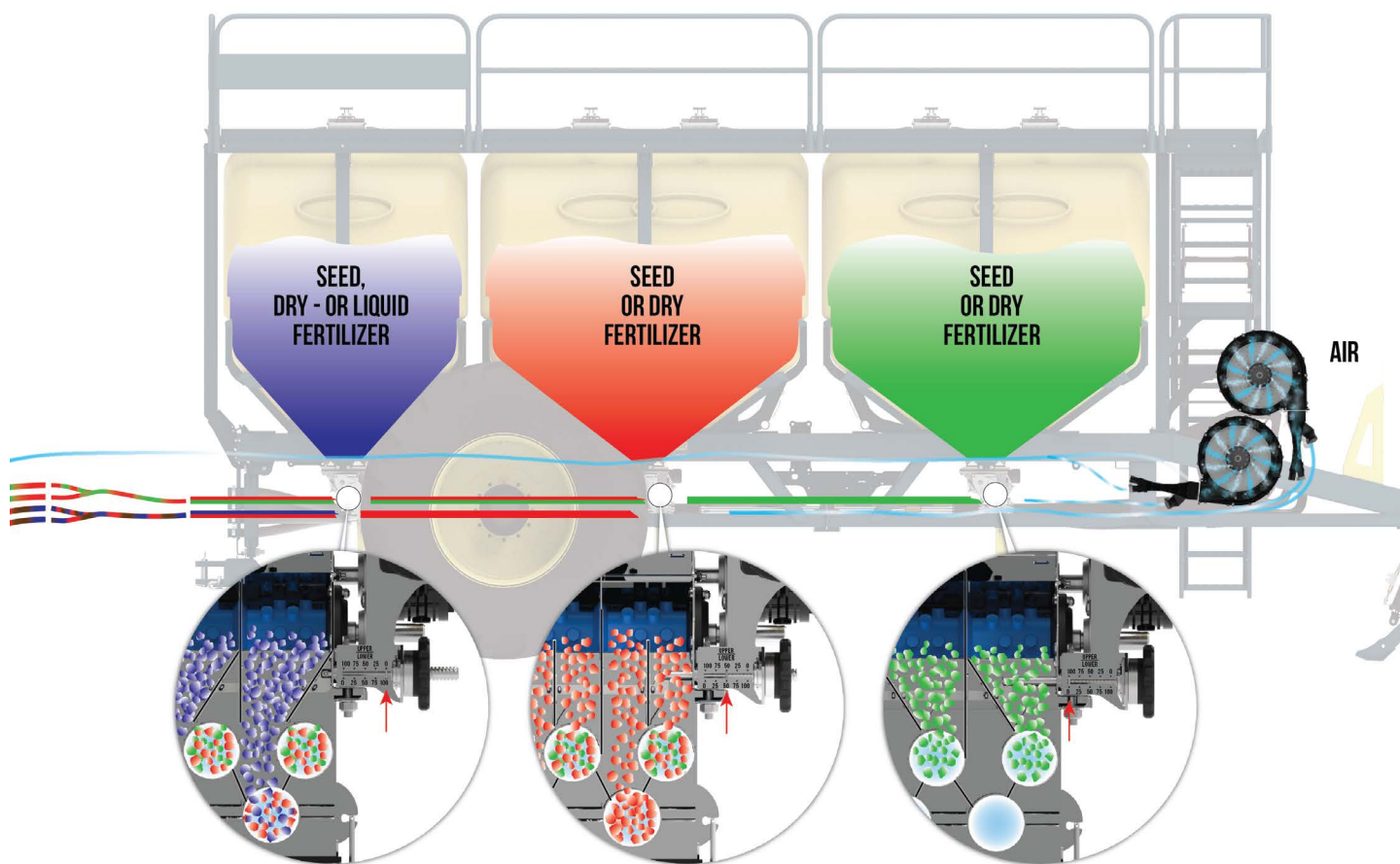

Granular fertilizer meter box

- Stainless steel with self-cleaning poly meter roller.
- Accurate, versatile, and simple with effortless calibration.
- One metering roller for all fertilizer and seed types and sizes.
- Direct fertilizer supply to each row for 8 - 16 row machines.

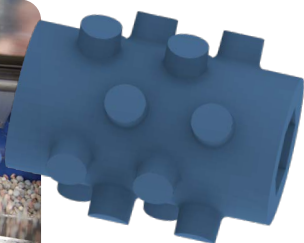

**NO ROLLER
CHANGES
REQUIRED**



Air Cart optional extras

- Scales for independent bins.
- Camera system in each tank.
- LED lights package.



General Enquiries

(+27)21 981 2161

info@equalizer.co.za

www.equalizer.co.za



EQUALIZER

PLANTING YOUR FUTURE